

CAJA DE MANDOS - *Control box assy* - Scatola comandi

MOTOR - Engine - Motore
F20 & F25

ARRANQUE ELÉCTRICO
Electric start
Avviamento elettrico

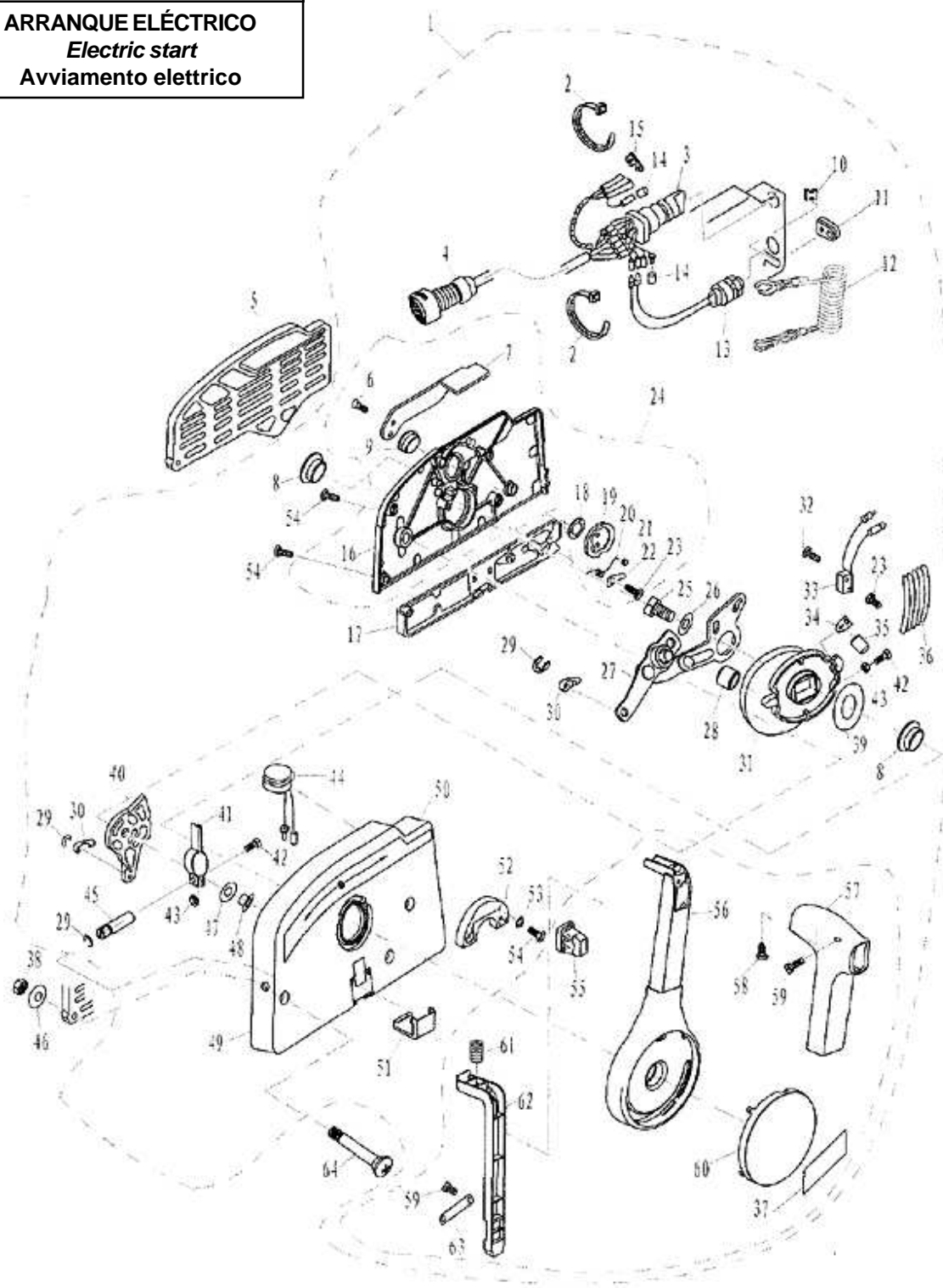

CAJA DE MANDOS - Control box assy - Scatola comandi

Nº	REF. PARSUN Ref. Parsun Ref. Parsun	DESCRIPCIÓN Description Descrizione	CANTIDAD Quantity Quantità
1	PAF25-11000000W	CONTROL BOX ASS'Y	1
2	PAHT2.5*60	CLAMP	2
3	PAF15-13000200W	STARTING SWICH ASS'Y	1
4	PAF15-13000100W	CONTROL CABLE ASS'Y(5M=16.4')	1
5	PAF15-11000002W	PLATE,CONTROL BOX	1
6	PAGB/T819.2-1997	SCREW PAN HEAD M5X12	2
7	PAF15-13020007W	THROTTLE HANDLE, INCHING	1
8	PAF15-13000005W	BUSH, CAM	2
9	PAF15-13020006W	BUSH, HANDLE	1
10	PAF15-11000001W	BLOCK, RUBBER	1
11	PAF15-13000014W	JACKET, CABLE	1
12	PAF4-01090401	STOPER,HANG ROPE ASS'Y	1
13	PAF15-13020400W	ENGINE STOP SWICH ASS'Y	1
14	PAF15-13000203W	INSULATED PLUG "B"	2
15	PAF15-13000202W	INSULATED PLUG "A"	1
16	PAF15-13020001W	COVER, CONTROL BOX	1
17	PAF15-13000013W	SMALL COVER, CONTROL BOX	1
18	PAF15-13020005W	WASHER "B", WAVE	1
19	PAF15-13020100W	LOCKED DISK ASS'Y	1
20	PAF15-13020002W	TORSIONSPRING	1
21	PAF15-13020003W	EACH LOCKED PULLEY	1
22	PAF15-13020004W	PLATE, PULLEY SPRING	1
23	PAGB/T818-2000	PAN HEAD SCREW M4X6	2
24	PAF15-13020000W	COVER ASS'Y, CONTROL BOX	1
25	PAGB/T5783-2000	BOLT M8X30	1
26	PAGB/T97.1-85	WASHER 8	1
27	PAF15-13000500W	MACHINE, CONTROL ACCELEROGRAPH	1
28	PAF15-13000007W	WASHER	1
29	PAGB/T896-1986	PINÿCOTTER 6	3
30	PAF25-07000007W	CONTROL CABLE TIE IN "B"	2
31	PAF15-13000002W	CAMMECHANISM	1
32	PAGB/T818-2000	PAN HEAD SCREW M3X14	2
33	PAF15-13000800W	INCHING SWITCH	1
34	PAF15-13000003W	PLATE	1
35	PAF15-13000004W	PULLEY	1
36	PAF15-13000001W	SHIFT SPRING PLATE "B"	5
37	PAF15-12000016W	MARK 16	1
38	PAGB/T6170-2000	NUT M6	3
39	PAF15-13000008W	WEARABLE PLATE, CAM MACHANISM	1
40	PAF15-13000700W	SHIFT SWING LINK	1
41	PAF15-13000601W	ADJUSTER FASTNESS ASS'Y	1
42	PAGB/T5783-2000	BOLT M5X25	2
43	PAGB/T6170-2000	NUT M5	2
44	PAF15-13000300W	BUZZER ASS'Y	1
45	PAF15-13000602W	ADJUSTER PIN	1
46	PAGB/T5287-1985	BIG WASHER 6	3
47	PAF15-13000006W	WEARABLE PLATE	1
48	PAF15-13000011W	BUSH, SHIFT SWING LINK	1
49	PAF15-13000012W	BRACKET, CONTROL BOX	1
50	PAF15-12000013W	MARK 13	1
51	PAF15-13000015W	COVER, WATERPROOF	1
52	PAF15-13010010W	BLOCK, CONTROL HANDLE	1
53	PAGB/T956.1-1987	WASHER, LOCKED 5	2
54	PAGB/T819.2-1997	SCREW, PAN HEAD M5X18	7
55	PAF15-13010003W	JAM, BUTTON	2
56	PAF15-13010001W	CONTROL HANDLE	1
57	PAF15-13010002W	CONTROL HANDLEBAR	1
58	PAGB/T84.5-2000	SCREW, PAN HEAD ST4.8X12	1
59	PAGB/T818-2000	SCREW, PAN HEAD M4X10	3
60	PAF15-13010009W	COVER, CONTROL HANDLE	1
61	PAF15-13010005W	SPRING, COMPRESSION	1
62	PAF15-13010004W	PART, ORIENTATION CONTROL	1
63	PAF15-13010008W	PLATE, ORIENTATION PART	1
64	PAGB/T820-2000	SCREW, PAN HEAD M6X90	3